

44 Basement Car spaces  
 8 Basement Motorcycle spaces  
 21 Street Car spaces

(As planning)

A width of 3.1m kerb to pedestrian ramp can not reasonably accommodate two way motor traffic.  
 A controlled entrance suitable for one direction of travel at any one time is appropriate given the low number of movements associated with the car park, thus allowing pedestrians pushing a bicycle unfettered access which would meet the Lambeth hierarchy for pedestrians and vehicles.

To achieve this a signalised entrance would be required directing motorists when they should undertake their movement to enter or exit the car park.

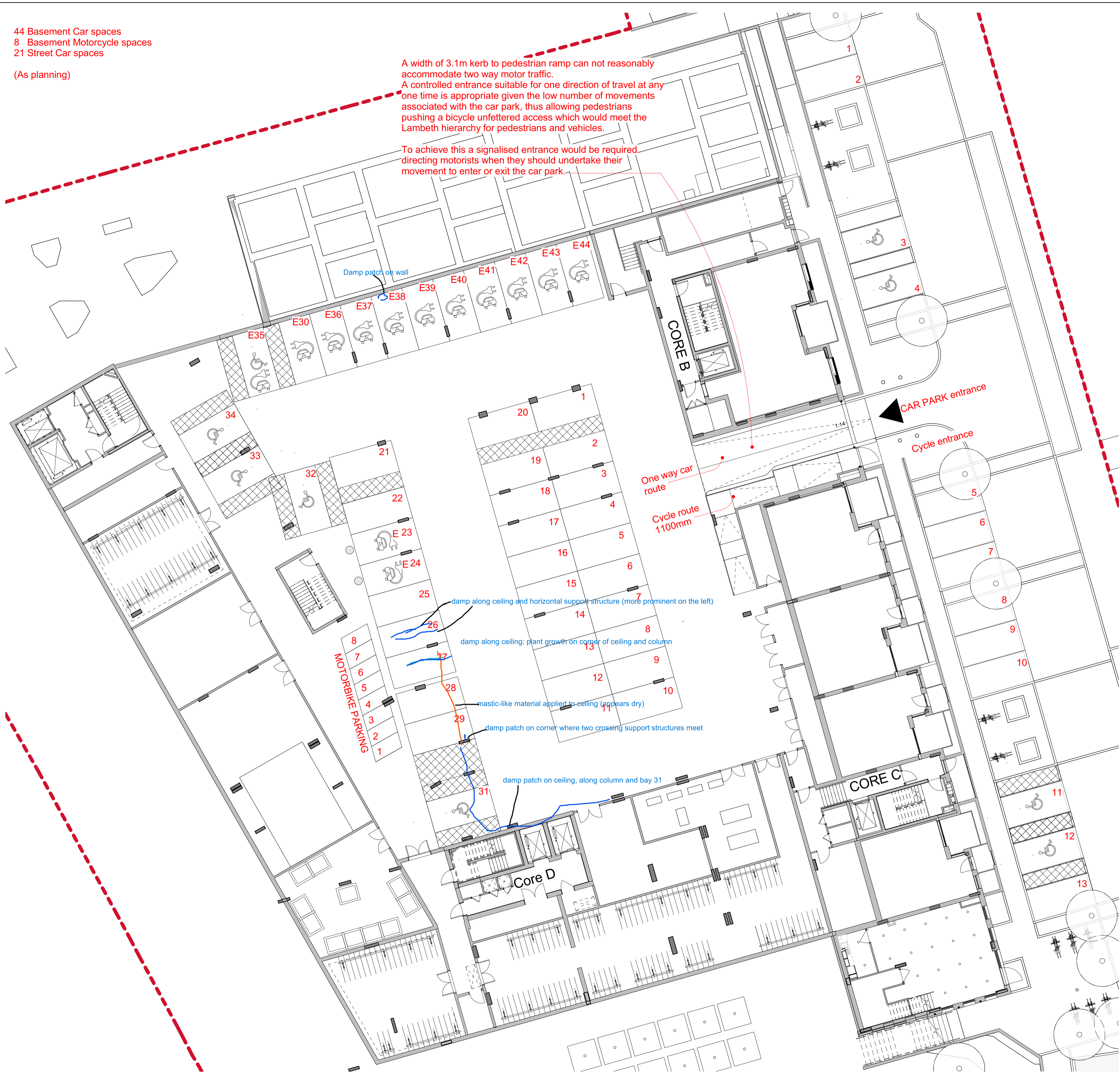

The contractor is responsible for checking dimensions, tolerances and references. Any discrepancy to be verified with the Architect before proceeding with the works. Where an item is covered by drawings to different scales the larger scale drawing is to be worked to.  
 Do not scale drawing. Figured dimensions to be worked to in all cases.  
 CDM REGULATIONS 2015. All current drawings and specifications for the project must be read in conjunction with the Designer's Hazard and Environment Assessment Record.  
 All intellectual property rights reserved.

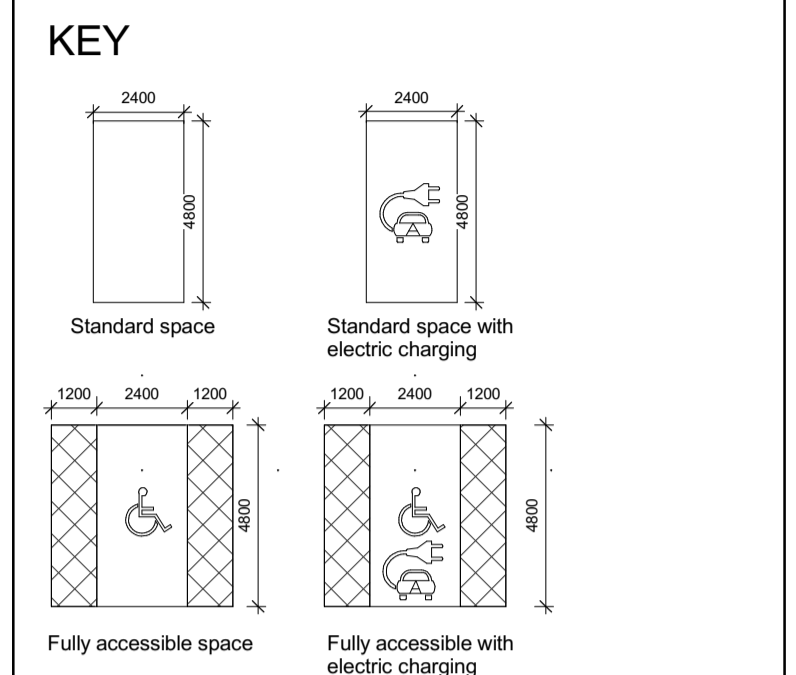

**Parking requirements**

Residential Units	177
Car Spaces	65
Motorcycle	8

**Carpark Space Provision**

Location	Space Type	No
Carpark	Fully accessible parking	4
Carpark	Fully accessible parking with electric charging	1
Carpark	Standard parking space	27
Carpark	Standard parking with electric charging	12
<b>Grand total</b>		<b>44</b>

**Home Zone Space Provision**

Location	Space Type	No
Home Zone	Fully accessible parking	4
Home Zone	Standard parking space	17
<b>Grand total</b>		<b>21</b>

**Motorcycle Space Provision**

Location	Space Type	No
Carpark	Motorcycle parking space	8
<b>Grand total</b>		<b>8</b>

Rev	Date	Description	EM	KvN	Dwn	Cld
05	21.02.2020	RECORD COPY - This drawing has been revised as directed by the contractor	HS	MW		
04	21.01.2020	Santander bicycles removed from plan.	MAW	SS		
03	15.05.2018	First Issue Stage 4. Parking bays updated.	MAW	DS		
02	18.11.2016	Issue for PCSA Report	DS	KvN		
01	21.06.2016	Initial Issue. Issued for information.	EM	KvN		

**THRAYLE HOUSE**  
 Car Parking

Project	Origin	Zone	Level	Type	Role	Number
THR	PRP	ZZZ	ZZZ	DR	A	5230
Revision						
05						
Status						
RECORD COPY						
Drawn	EM	Checked	KvN	Date	21.06.16	Scale @ A1 As indicated



**1** Car Parking Layout 01  
 1 : 150

**2** Car Parking Layout 02  
 1 : 150